

Z35/...

Mat.: min. 1455 N/mm²
DIN 913-45 H

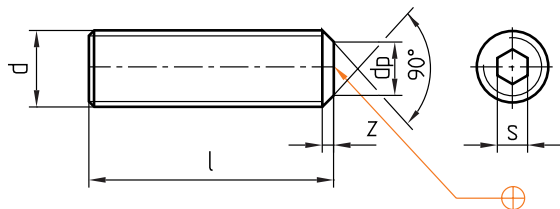

s	z	dp	d	l	Nr./No.
1,5	0,5	2	M3	6	Z35/3x 6
				8	8
2	0,75	2,5	M4	6	Z35/4x 6
				8	8
				10	10
				12	12
2,5	0,75	3,5	M5	6	Z35/5x 6
				8	8
				10	10
				12	12
				16	16
3	1	4	M6	6	Z35/6x 6
				8	8
				10	10
				12	12
				16	16
				20	20

s	z	dp	d	l	Nr./No.
4	1,25	5,5	M 8	8	Z35/ 8x 8
				10	10
				12	12
				16	16
				20	20
5	1,5	7	M10	10	Z35/10x10
				12	12
				16	16
				20	20
				30	30
6	1,75	8,5	M12	12	Z35/12x12
				16	16
				20	20
				30	30
				40	40
8	2	12	M16	20	Z35/16x20
				30	30
				40	40

Z351/...

Mat.: min. 1455 N/mm²
≈ DIN 913-45 H

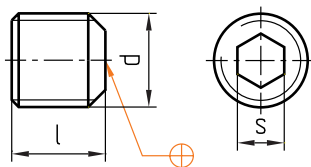

Neu / New / Nouveau

s	d	l	Nr./No.
5	M10x1	12	Z351/10x1 /12
6	M12x1,5		12x1,5/12
8	M16x1,5	25	16x1,5/25